

Schottky Barrier Diode

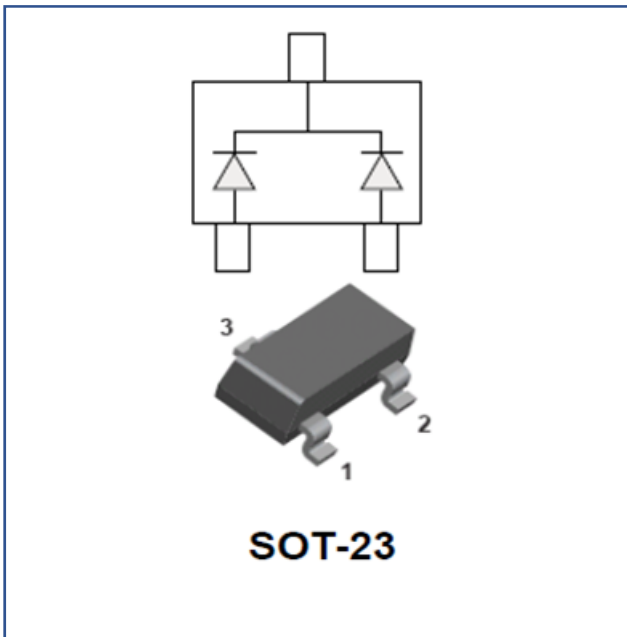

Features

- Moisture sensitivity level 1
- Reverse voltage: 40V
- Average forward current : 500mA

Application

- Low Forward Voltage
- Surface Mount Device

Mechanical data

- **Package:** SOT-23
- **Terminals:** Tin plated leads, solderable per J-STD-002 and JESD22-B102

■ Maximum Ratings (T_a=25°C Unless otherwise specified)

PARAMETER	Symbol	Unit	Value
Device marking code			SF3
Repetitive peak reverse voltage	V _{RRM}	V	40
Forward current	I _F	mA	500
Non-Repetitive Surge peak forward current @ t=8.3ms half-sine wave	I _{FSM}	A	2
Power Dissipation	P _D	mW	300
Junction temperature	T _J	°C	-55 to +125
Storage temperature	T _{STG}	°C	-55 to +125

SBT0540C

■ Electrical Characteristics (T_a=25°C Unless otherwise specified)

PARAMETER	Symbol	UNIT	Conditions	Min	TYP	Max
Reverse voltage	V _R	V	IR=100uA	40	-	-
Forward Voltage	V _F	V	IF=10mA	-	-	0.3
			IF=200mA	-	-	0.5
Reverse Leakage Current	I _R	uA	VR=25V	-	-	70
Junction capacitance	C _j	pF	VR=0V,f=1MHz	-	-	100

■ Thermal Characteristics

PARAMETER	Symbol	Unit	Value
Thermal resistance, junction-to-ambient	R _{θJ-A} ⁽¹⁾	°C/W	333

Note:

(1) Thermal resistance from junction to ambient mounted on PCB, single-sided copper, with standard footprint.

SBT0540C

■ Characteristics

Fig 1: PD-TA Curve

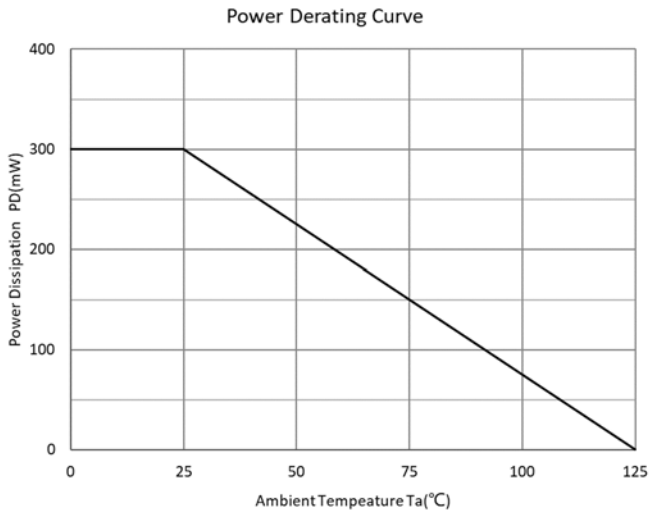

Fig 2: Capacitance Capability

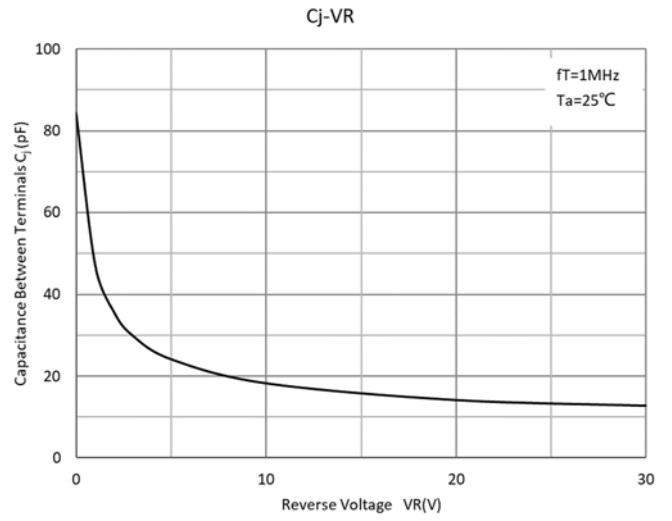

Fig 3: Typical Forward Characteristics

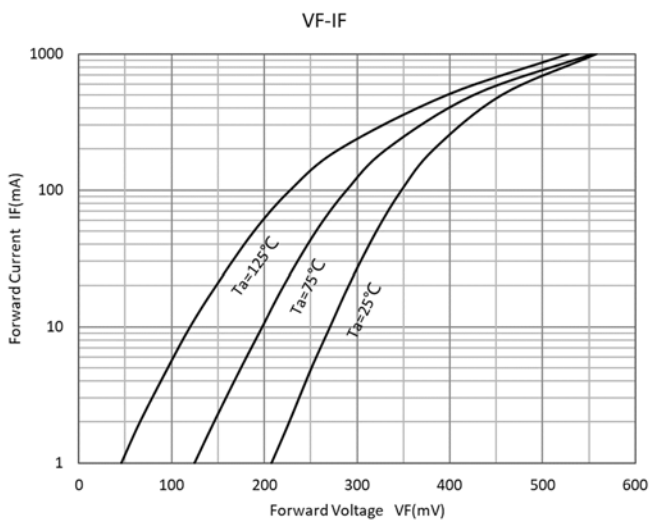
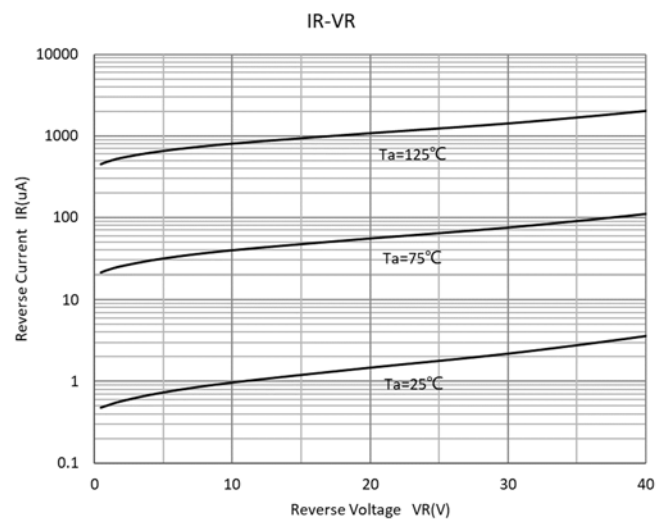

Fig 4: Typical Reverse Characteristics



SBT0540C

■ Ordering Information

PREFERRED P/N	PACKING CODE	UNIT WEIGHT(g)	MINIMUM PACKAGE(pcs)	INNER BOX QUANTITY(pcs)	OUTER CARTON QUANTITY(pcs)	DELIVERY MODE
SBT0540C	F2	Approximate 0.008	3000	30000	120000	7" reel

■ Outline Dimensions

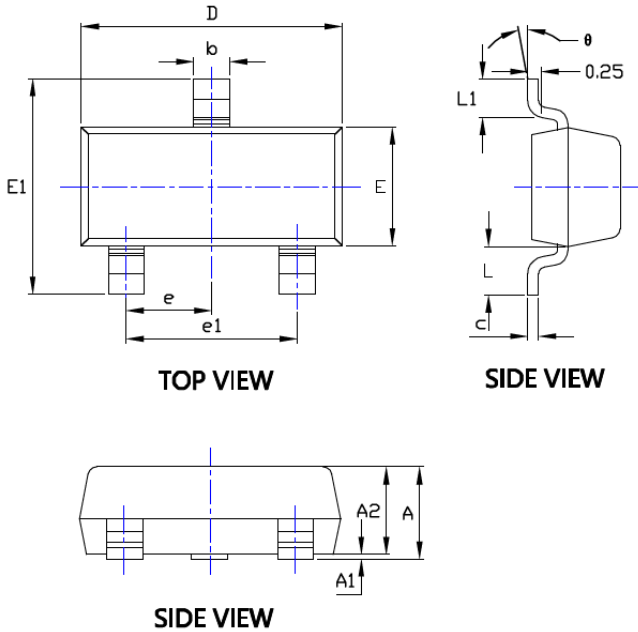

SYMBOL	DIMENSIONS			
	INCHES		Millimeter	
	MIN.	MAX.	MIN.	MAX.
A	0.035	0.045	0.900	1.150
A1	0.000	0.004	0.000	0.100
A2	0.035	0.041	0.900	1.050
b	0.012	0.020	0.300	0.500
c	0.004	0.008	0.100	0.200
D	0.110	0.118	2.800	3.000
E	0.047	0.055	1.200	1.400
E1	0.089	0.100	2.250	2.550
e	0.037TYP		0.950TYP	
e1	0.071	0.079	1.800	2.000
L	0.022REF		0.550REF	
L1	0.012	0.020	0.300	0.500
θ	0°	8°	0°	8°

■ Suggested Pad Layout

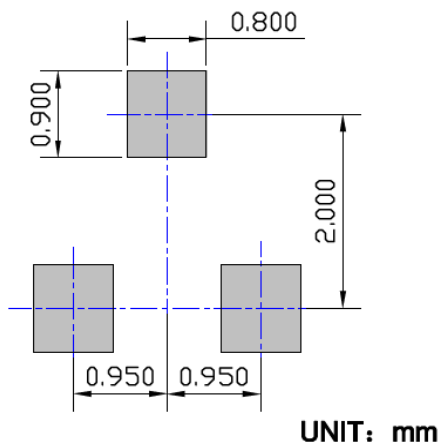

SBT0540C

Disclaimer

The information presented in this document is for reference only. Yangzhou Yangjie Electronic Technology Co., Ltd. reserves the right to make changes without notice for the specification of the products displayed herein to improve reliability, function, or design or otherwise.

The product listed herein is designed to be used with ordinary electronic equipment or devices, and not designed to be used with equipment or devices which require high level of reliability and the malfunction of which would directly endanger human life (such as medical instruments, transportation equipment, aerospace machinery, nuclear-reactor controllers, fuel controllers and other safety devices), Yangjie or anyone on its behalf, assumes no responsibility or liability for any damages resulting from such improper use of sale.

This publication supersedes & replaces all information previously supplied. For additional information, please visit our website [http:// www.21yangjie.com](http://www.21yangjie.com) , or consult your nearest Yangjie's sales office for further assistance.